

PowerJolt

Thank you for purchasing Griffin Technology's PowerJolt in-car charger for iPhone and iPod. PowerJolt is simple and easy to use. Here's how:

Connect

- ▶ Plug PowerJolt into your car's cigarette lighter or 12V accessory power port.
- ▶ Plug detachable charge/sync cable's USB connector into the PowerJolt charger.
- ▶ Plug dock connector into your iPod or iPhone.

You can also use PowerJolt's charge/sync cable to connect your iPhone or compatible iPod to your computer, to charge or sync.

Charge

PowerJolt's LED shows charging status at a glance

- ▶ Green = PowerJolt is correctly plugged in, ready to charge your iPod or iPhone.
- ▶ Amber = PowerJolt is charging your iPod or iPhone.

Compatibility

PowerJolt for iPhone is also compatible with the following iPod models.

- ▶ iPod nano (2nd generation)
- ▶ iPod with video (5th generation)
- ▶ iPod nano (1st generation)
- ▶ iPod shuffle (1st generation)
- ▶ iPod (with color display)
- ▶ iPod mini
- ▶ iPod shuffle (2nd generation: with your original iPod shuffle cable)

Special note: When power is removed the iPod or the iPhone may or may not go into pause mode.

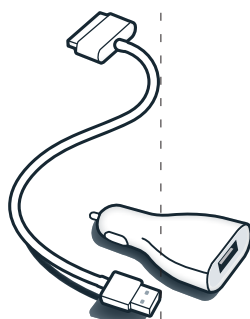
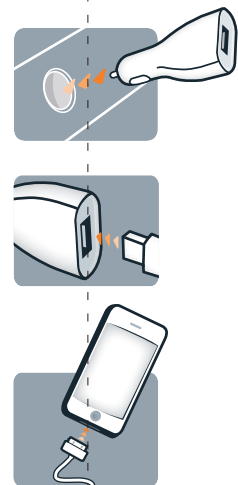

quick start guide

Troubleshooting

Connected iPod or iPhone is not charging, or there is no LED showing.

Check:

- PowerJolt fully plugged into lighter or power socket?
- Is dock connector firmly connected to your iPhone or iPod?
- If you're using PowerJolt's detachable charge/sync cable with your Mac or PC, is the USB plug attached to a powered USB port?
- Has your car's lighter fuse blown? (Check your owners' manual for instructions on locating and replacing the fuse.)
- Has PowerJolt's fuse blown? Replace with a mini automotive fuse (sometimes called a mini ATM-type fuse) rated at 2 amps, available at most general retailers, electronics and auto parts suppliers. For best results, remove and take the blown fuse with you to ensure a match.

Tech Specs

- ▶ Input voltage range: 12 ± 14 Volts DC
- ▶ Maximum current: 2 Amp
- ▶ Output voltage: 5.2 Volts DC at 1 Amp
- ▶ Fuse type: 2 Amp blade-type (mini-ATM) automotive fuse

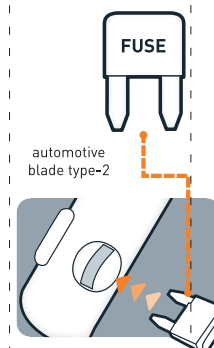

GRIFFIN

1 YEAR WARRANTY

Warranty details at www.griffintechnology.com/support/. Griffin stands behind every product with the industry's best customer service, backed by a simple, fair warranty.

© 2007 Griffin Technology • www.griffintechnology.com • PowerJolt is a registered trademark of Griffin Technology, Inc. • iPhone is a trademark of Apple Inc. • iPod is a trademark of Apple Inc., registered in the U.S. and other countries. • Patents Pending. Made in China • Designed in Tennessee

Made for iPod means that an electronic accessory has been designed to connect specifically to iPod and has been certified by the developer to meet Apple performance standards. • *Works with iPhone* means that an electronic accessory has been designed to connect specifically to iPhone and has been certified by the developer to meet Apple performance standards. Apple is not responsible for the operation of this device or its compliance with safety and regulatory standards.



This device complies with Part 15 of the FCC Rules. Operation is subject to the following two conditions:
(1) this device may not cause harmful interference, and
(2) this device must accept any interference received, including interference that may cause undesired operation.

