

# AirClickUSB Quick Start Manual



## What Do I Need?

To use AirClickUSB, you'll need the following:

- A Macintosh running Mac OS X or a PC running Windows XP
- An available USB port
- CD-ROM Drive

## What Is All This Stuff?

AirClick USB features two key pieces: the Remote Control and the Receiver Module. Let's take a look:

### Remote Control

- ▶ Play/Pause
- ▶ Next/Fast Forward
- ▶ Previous/Rewind
- ▶ Volume Up
- ▶ Hold Switch (Orange = Hold)
- ▶ Volume Down

### Receiver Module

- LED (illuminates when receiving a command)
- USB Plug (connect to your Mac or PC)
- Pairing Switch (Back of unit. See PAIRING)

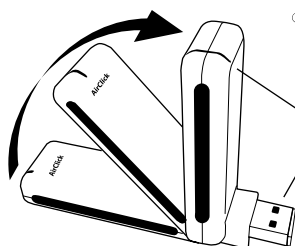

## Let's Install it.

**Hardware Installation:** Simply plug the Receiver Module into any USB port on your Mac or PC.

**Software Installation:** AirClickUSB requires the installation of a small software application on your computer. Just follow the instructions for your type of computer, below.

**Mac:** Insert the included CD into your Mac, and double-click the AirClickUSB installer. The AirClickUSB application will be installed into your Applications folder.

**Windows:** Insert the included CD into your PC. The AirClickUSB installer will launch automatically. Follow the prompts to install the AirClick application.

## How Do I Use It?

AirClickUSB works with a variety of popular applications, such as iTunes, QuickTime Player, and PowerPoint. We'll show you how to use AirClickUSB by showing how it works with iTunes. Other applications will work in a similar manner, and you can find a full, up-to-date listing of all compatible applications and their controls by visiting our Support website at: <http://www.griffintechnology.com/support/airclick>

## Using AirClickUSB with iTunes – An Example

### Select iTunes in the AirClickUSB Application

**Mac:** Double-Click the AirClickUSB icon in your Applications folder to launch the AirClickUSB software. Click the AirClickUSB icon that appears in your menu bar to display the list of AirClick-controllable applications. Select iTunes in this list to choose it as the application you wish to control.

**Windows:** Right-Click the AirClickUSB icon that appears in your System Tray to display the list of AirClick-controllable applications. Select iTunes in this list to choose it as the application you wish to control.

**Open iTunes:** Pressing any button on the Remote Control will open iTunes.

## Using AirClickUSB is as simple as using iTunes. The buttons on the Remote Control are very similar to the controls in iTunes.

<b>Play a Song:</b>	If a song is paused, pressing the Play/Pause (▶) Button will play that song. Note: If no song has been selected or is paused, pressing the Play/Pause button will cause iTunes to start playing all of the music in the iTunes Library.
<b>Pause a Song:</b>	Press the Play/Pause (▶) Button while a song is playing.
<b>Go to Next Song:</b>	Press the Fast Forward (▶▶) Button.
<b>Go to Previous Song:</b>	Press the Rewind (◀◀) Button.
<b>Fast Forward Song:</b>	Press/Hold the Fast Forward (▶▶) Button.
<b>Rewind Song:</b>	Press/Hold the Rewind (◀◀) Button.
<b>Increase Volume:</b>	Press the Volume Up (◀▶) Button.
<b>Decrease Volume:</b>	Press the Volume Down (▶▶) Button.

## Pairing

By default, all AirClicks work on the same "channel." If you have more than one AirClick Remote within range of an AirClick Receiver Module, the Receiver will happily take commands from both Remotes. Since you probably don't want this to happen, you can tell the Receiver to accept commands only from a specific AirClick Remote through a process called Pairing. Use Pairing whenever more than one AirClick Remote will be used in the same area.

### Turn Pairing On:

- Press the Pairing Switch on the Receiver Module by inserting a straightened paper clip or similar device. The LED on the Receiver will light up
- Press any button on the Remote within five seconds
- The LED on the Receiver will flash rapidly for one second, indicating that Pairing was successful

You'll find the pairing button on the back of your receiver.

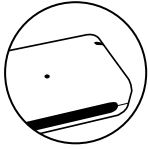

### Turn Pairing Off:

To reverse the process, allowing the Receiver Module to once again be controlled by any Remote Control, simply use a straightened paper clip or similar device to press the Pairing Switch on the Receiver Module. DO NOT press any buttons on the Remote Control. After five seconds, the LED on the Receiver will turn off, and it will again respond to any AirClick Remote Control.

## Frequently Asked Questions

*My AirClickUSB doesn't seem to be accepting commands. What can I do?* First, make sure you have the AirClickUSB software installed. Next, make sure that the application you want to control is selected in the AirClickUSB application (see How Do I Use It?). If you have the Receiver Module plugged into a USB port on a keyboard or hub, try plugging it into a built-in USB port on your Mac or PC.

*Will I need to replace the battery?* With normal use, the AirClick Remote's battery should last for the life of the product. Should the battery need to be replaced, open the Remote Control unit by removing the three small screws, and replace with a CR2032-type battery or equivalent.

*Can I use this AirClick Remote with an AirClick for iPod?* Absolutely. The AirClick Remote can control Receiver Modules for AirClick, AirClick mini, and AirClickUSB.

*Can I use multiple AirClicks in the same room/house?* Yes, but you'll want to "Pair" the AirClicks to prevent unwanted commands from being sent or received. (See Pairing.)

## Remote Control Technical Specifications

- Transmission: Radio Frequency
- Frequency: 433.92MHz
- Operating Range: Up to 60ft
- Battery: CR2032 3V
- Dimensions: 2.75" x 1.25" x 0.5" (0.75" max depth including belt clip)
- Weight (including battery): 0.8 oz

**FCC COMPLIANCE:** This device complies with part 15 of the FCC rules. Operation is subject to the following two conditions: (1) this device may not cause harmful interference, and (2) this device must accept any interference received, including interference that may cause undesired operation. CAUTION: Changes or modifications not expressly approved by the party responsible for compliance could void the user's authority to operate the equipment.

**WARRANTY:** Griffin Technology offers a one year limited warranty on all products sold. We warrant our retail hardware products to be free of defects in materials and workmanship that result in failure during normal usage. This warranty extends to the original end-user purchaser from the time of retail purchase. The limited warranty does not cover misuse, unauthorized modifications, and external causes, such as acts of nature. This limited warranty is the sole and exclusive remedy and is in lieu of all other warranties, expressed or implied. Griffin will not be liable for any indirect, incidental, or punitive damages arising from use of this product.

## Questions?

<http://www.griffintechnology.com/support/>  
615-399-7000 (M-F 9-6 CST)